

TS110a $\pm 20\text{Nm}$, $\pm 50\text{Nm}$, $\pm 100\text{Nm}$, $\pm 200\text{Nm}$

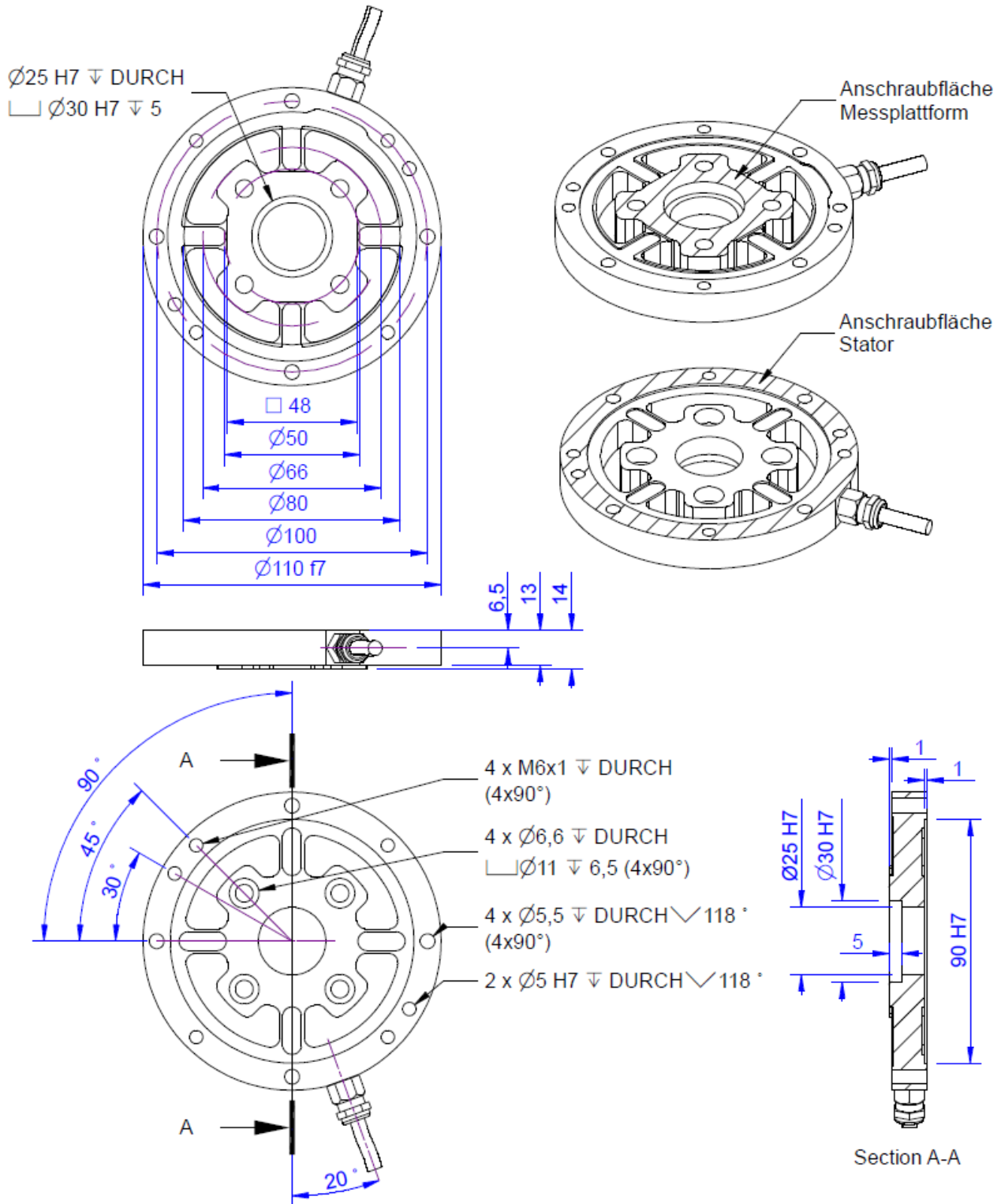

Description

Dimensions



Technical Data

Basis Data

Type	shear beam	
Bending moment limit	20	Nm
Maximum operating torque	150	%FS
Breaking torque	400	%FS
Rated torsion angle	0.02	°/FS
Axial force limit	1000	N
Lateral force limit	1000	N
Torque introduction	pitch circle	
Dimension 1	Ø50	
drehmomentausleitung	pitch circle	
Dimension 2	Ø100	
Diameter	110	mm
length	14	mm

Electrical Data

Input resistance	2000	Ohm
Tolerance input resistance	10	Ohm
Output resistance	2000	Ohm
Tolerance output resistance	10	Ohm
Insulation resistance	5	GOhm
Rated range of excitation voltage f	2.5 ... 5	V
Operating range of excitation voltage f	1 ... 10	V
Zero signal	0.05	mV/V
Rated output	1	mV/V / FS

Precision

Accuracy class	0.1	
Relative linearity error	0.1	%FS
Relative zero signal hysteresis	0.1	%FS
Temperature effect on zero signal	0.01	%FS/K
Temperature effect on characteristic value	0.01	%RD/K
Relative creep	0.05	%FS

Connection Data

Connection type	4 conductor open	
Name of the connection	Unitronic FD CP Plus / 4x0,14	
Cable length	3	m

Temperature

Rated temperature range f	-10 ... 60	°C
Operating temperature range f	-10 ... 85	°C
Storage temperature range f	-10 ... 85	°C
Environmental protection	IP65	



Abbreviation: RD: „Reading“; FS: „Full Scale“;

1) The exact nominal sensitivity is indicated in the test report;







Pin Configuration

Symbol	Description	Wire colour
+Us	positive bridge supply	brown
-Us	negative bridge supply	white
+Ud	positive bridge output	green
-Ud	negative bridge output	yellow

Pressure load: positive output signal.

Shield: transparent.

accessories

Description	Description
 Factory calibration certificate Nm/50/5	Detection of the characteristic value and the traceability to DKD torque device
 Factory calibration certificate Nm/50/5/System	Proof of the characteristic value and the traceability on DAkKS torque device, including system calibration
 Factory calibration certificate Nm/200/5	Detection of the characteristic value and the traceability to DKD torque device
 Factory calibration certificate Nm/200/5/System	