

Load Cell LCB150

Nominal load ranges (compression) 1kg, 5kg, 10kg, 20kg, 30kg, 50kg, 100kg

The load cell LCB130 is a load cell of high precision for use in weighing platforms. It allows the installation of a platform sized up to 400mm x 400mm. The error due to excentric load is less than 0.008% per 10mm excentricity.

The load cell LCB150 conforms to the stringent European requirements for use in trade approved scales. Environmental protection is according to IP 66.



Dimensions

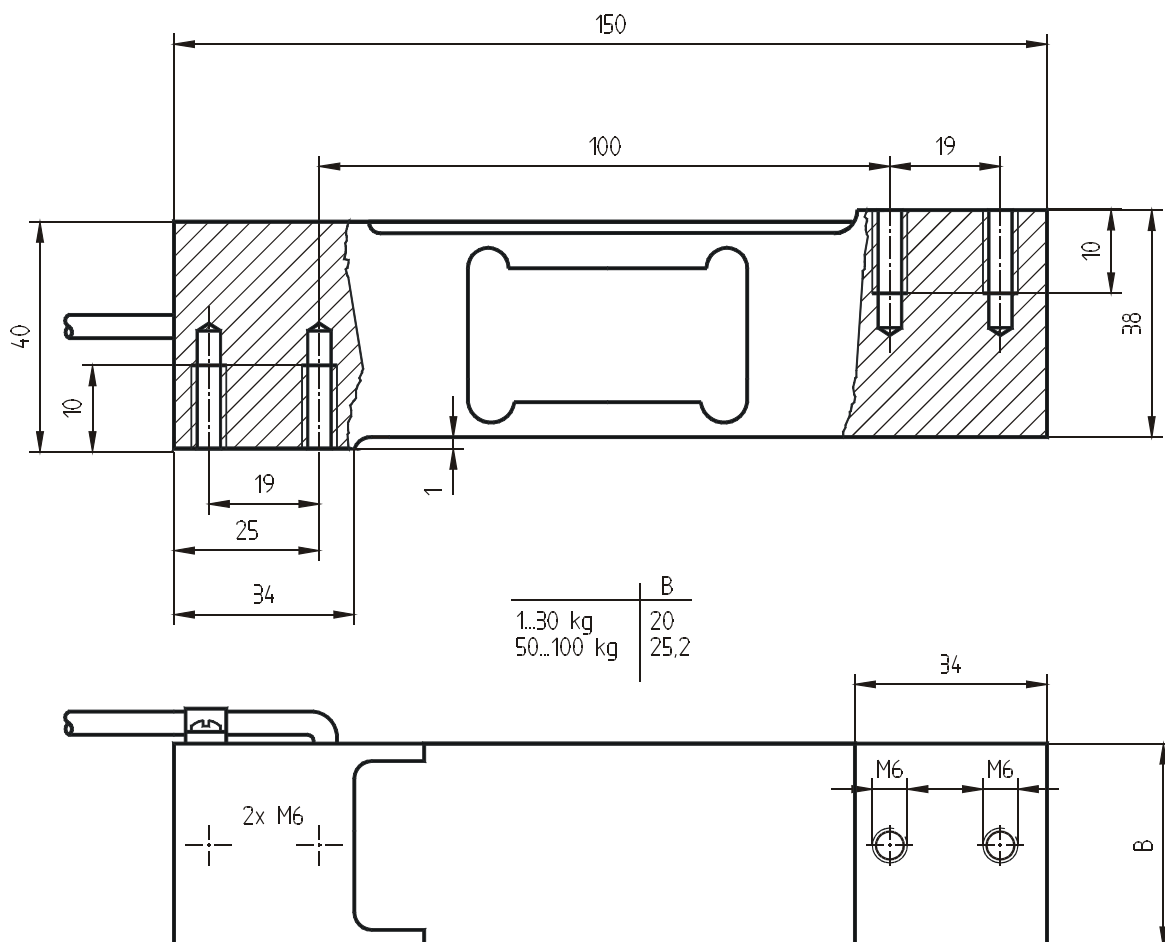



Load Cell LCB150

Nominal load ranges (compression) 1kg, 5kg, 10kg, 20kg, 30kg, 50kg, 100kg

Technical Data

Load cell	compression
Construction	bending beam
Material	aluminum alloy
Accuracy classes	C1 (0.023%), C3 (0.02%)
Nominal loads (F _N)	1kg...100kg

Accuracy class accord. to OIML R60	C1	C3	
Maximum scale division value	1000	3000	
Combined error	< ±0.03	< ±0.020	% S _N
Creep error (30 min)	< ±0.05	< ±0.017	% S _N
Temperature coeff. of the zero signal	< ±0.01	< ±0.004	% F _N /10°C
Temperature coeff. of the nominal output	< ±0.03	< ±0.01	% S _N /10°C

Operating load	150	% F _N
Breaking load	300	% F _N

Nominal temperature range	-10...+40	°C
Operating temperature range	-30...+70	°C
Storage temperature range	-30...+70	°C

Nominal output (S _N)	2.0 ±10%	mV/V
Zero signal tolerance	±10	% F _N
Max. supply voltage	15	V
Input resistance	415 ±15	Ohm
Output resistance	350 ±3.5	Ohm
Insulation resistance	> 2 · 10 ⁹	Ohm
Connection, 6-conductor open	1	m

Pin Configuration

+Us	positive bridge supply	green
-Us	negative bridge supply	black
+UF	positive sensor wire	blue
-UF	negative sensor wire	brown
+UD	positive bridge output	red
-UD	negative bridge output	white