

Plug gauge KB16x32

Measuring range $\pm 1\text{kN}$, $\pm 5\text{kN}$, $\pm 10\text{kN}$



Discription

The plug gauge KB16x32 can be used to measure the force in connection with a fork head of the DIN 71152 / DIN ISO 8140.

Dimensions

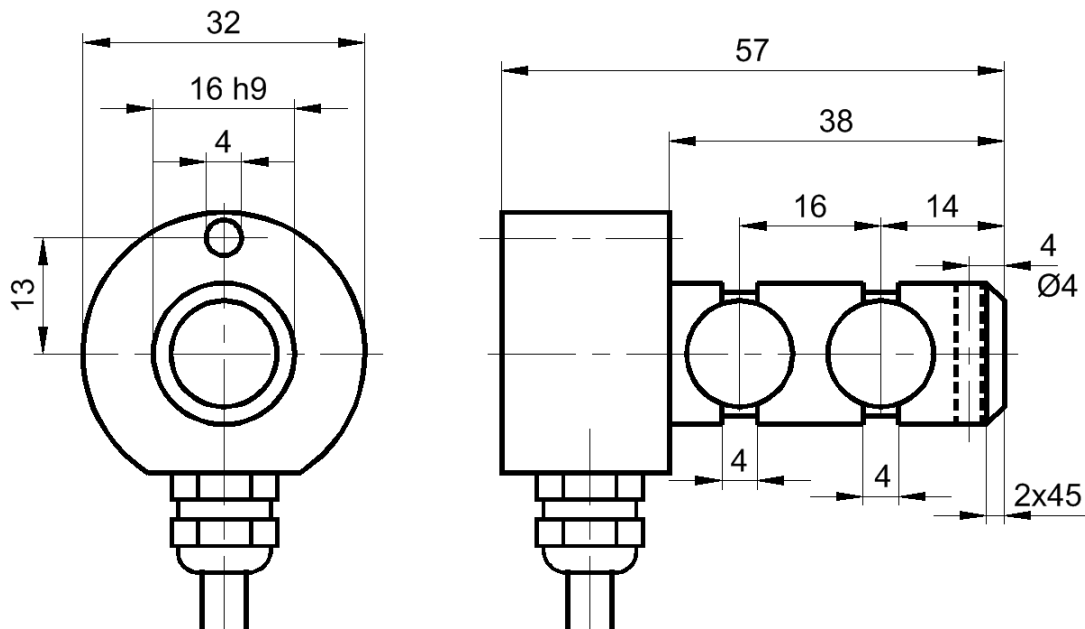

Technical datas

Plug gauge	Shearing	
Mounting form	Shearing force bolt	
Material	Steel	
Nominal load (F_N)	$\pm 1, \pm 5, \pm 10,$	kN
Specific value	1 ¹⁾	mV/V
Nominal temperature range	+10...+65	°C
Operating temperature range	-20...+85	°C
Storage temperature range	-40...+85	°C
maximum supply voltage	5	V
Isolation resistance	$> 5 \cdot 10^9$	Ohm
Connection 4 wires open	5	m
Linearity mistake	≤ 1	% S_N
Reversal error	≤ 1	% S_N
Temperature coefficient of the zero signal	$\leq \pm 0,02$	% F_N / K
Temperature coefficient of the specific value	$\leq \pm 0,03$	% S_N / K
Zero point bridge deviation (30 min)	$\leq 0,1$	% S_N
Creep deviation (30 min)	$\leq 0,1$	% S_N

1) The specific value of the bolt can vary from 1,0 mV/V and is shown in the test chart.

Pin configuration

+Us	positive bridge supply	brown
-Us	negative bridge supply	white
+U _D	positiver bridge output	green
-U _D	negativer bridge output	yellow